

# SAMPLE BALLOT

DEMOCRATIC, REPUBLICAN & NON-PARTISAN PRIMARIES  
 FORSYTH COUNTY, NORTH CAROLINA  
 JULY 20, 2004

## Voting Instructions

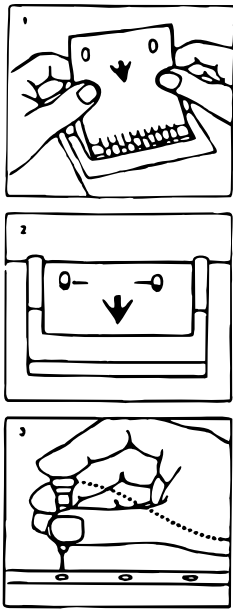

- Step 1** Using both hands, insert the ballot card all the way into the Vote Recorder.
- Step 2** Be sure the two slots in the end of your card fit down **over the two red pins**.
- Step 3** To vote, hold the voting instrument **straight up**. **Punch straight down** through the ballot card for the candidate of your choice. **Do not use pen or pencil**.
- Step 4** **Vote all pages.**
- Step 5** After voting, remove the ballot card from the Vote Recorder.
- Note:** If you make a mistake, return your ballot card and obtain another.

*Mrs. Charles A. Cardwell, Jr.*  
 Mrs. Charles A. Cardwell, Jr., Chair  
 Forsyth County Board of Elections

**ALL PRECINCT VOTING PLACES OPEN 6:30 A.M. TO 7:30 P.M.**

**FORSYTH COUNTY BOARD OF ELECTIONS 703-2800**

## SPECIAL NOTICE

**A VOTER IS LIMITED TO NO MORE THAN FIVE (5) MINUTES IN THE VOTING BOOTH WHEN OTHERS ARE WAITING TO VOTE. THE VOTER MAY MARK THIS SAMPLE BALLOT AND TAKE IT INTO THE VOTING BOOTH FOR REFERENCE PURPOSES. THIS SAMPLE BALLOT SHOULD NOT BE ALTERED OR MARKED BY ANYONE EXCEPT THE VOTER.**

## DEMOCRATIC PRIMARY

UNITED STATES CONGRESS - 5TH DISTRICT You May Vote for One Puedes votar para uno	JIM A. HARRELL, JR.	3 ➡
	ROGER N. KIRKMAN	4 ➡
	ANDREW WINFREY	5 ➡
UNITED STATES CONGRESS - 12TH DISTRICT You May Vote for One Puedes votar para uno	KIMBERLY (KIM) HOLLEY	6 ➡
	MEL WATT	7 ➡
GOVERNOR You May Vote for One Puedes votar para uno	MIKE EASLEY	9 ➡
	RICKEY KIPFER	10 ➡
LIEUTENANT GOVERNOR You May Vote for One Puedes votar para uno	CURTIS R. HERT, JR.	11 ➡
	BEVERLY EAVES PERDUE	12 ➡
COMMISSIONER OF AGRICULTURE You May Vote for One Puedes votar para uno	BRITT COBB	13 ➡
	TOM GILMORE	14 ➡
SECRETARY OF STATE You May Vote for One Puedes votar para uno	ELAINE F. MARSHALL	15 ➡
	DORIS A. SANDERS	16 ➡
SUPERINTENDENT OF PUBLIC INSTRUCTION You May Vote for One Puedes votar para uno	J.B. BUXTON	17 ➡
	MARSHALL STEWART	18 ➡
STATE SENATE - 32ND DISTRICT You May Vote for One Puedes votar para uno	JERMAINE BAXTER	21 ➡
	LINDA GARROU	22 ➡

## REPUBLICAN PRIMARY

LIEUTENANT GOVERNOR You May Vote for One Puedes votar para uno	TIMOTHY COOK	116 ➡
	JIM SNYDER	117 ➡
	THOMAS STITH	118 ➡
ATTORNEY GENERAL You May Vote for One Puedes votar para uno	THOM GOOLSBY	119 ➡
	JOE KNOTT	120 ➡
	WENDELL H. SAWYER	121 ➡
STATE AUDITOR You May Vote for One Puedes votar para uno	LESLIE MERRITT	122 ➡
	JASPER N. ALBRIGHT	123 ➡
COMMISSIONER OF INSURANCE You May Vote for One Puedes votar para uno	C. ROBERT BRAWLEY	125 ➡
	CINDY C. HUNTSBERRY	126 ➡
COMMISSIONER OF LABOR You May Vote for One Puedes votar para uno	CHERIE BERRY	128 ➡
	LLOYD T. FUNDERBURK	129 ➡
SUPERINTENDENT OF PUBLIC INSTRUCTION You May Vote for One Puedes votar para uno	BILL FLETCHER	131 ➡
	JEANNE J. SMOOT	132 ➡
STATE HOUSE-73RD DISTRICT You May Vote for One Puedes votar para uno	LARRY R. BROWN	135 ➡
	MICHAEL (MIKE) DECKER, SR.	136 ➡
	WINFIELD BEROETH	138 ➡
STATE HOUSE - 74TH DISTRICT You May Vote for One Puedes votar para uno	DEBRA CONRAD-SHRADER	139 ➡
	JONATHAN DILLS	140 ➡
	DALE R. FOLWELL	141 ➡
	DERRICK G. HINSON, SR.	142 ➡
	TOM SOUTHERN	143 ➡
	JOSH WOOD	144 ➡
	COUNTY COMMISSIONER - DISTRICT B You May Vote for Three Puedes votar para tres	LOUIS (LOU) BALDWIN, JR.
RICHARD V. LINVILLE	146 ➡	
PATRICIA L. MESSICK	147 ➡	
ROBERT S. (BOB) PARKER	148 ➡	
BILL ROBERTS	149 ➡	
GLORIA D. WHISENHUNT	150 ➡	
BILL WHITEHEART	151 ➡	

## REPUBLICAN PRIMARY

UNITED STATES SENATE You May Vote for One Puedes votar para uno	RICHARD BURR	97 ➡
	JOHN ROSS HENDRIX	98 ➡
	ALBERT LEE WILEY, JR.	99 ➡
UNITED STATES CONGRESS - 5TH DISTRICT You May Vote for One Puedes votar para uno	ED BROYHILL	100 ➡
	JOSEPH H. (JOE) BYRD	101 ➡
	VIRGINIA FOXX	102 ➡
	JAY HELVEY	103 ➡
	EDWARD L. (ED) POWELL	104 ➡
	MR. VERNON L. ROBINSON	105 ➡
	NATHAN TABOR	106 ➡
	DAVID STEPHEN VANHOY	107 ➡
GOVERNOR You May Vote for One Puedes votar para uno	PATRICK J. BALLANTINE	108 ➡
	DAN BARRETT	109 ➡
	BILL COBEY	110 ➡
	GEORGE W. LITTLE	111 ➡
	FERN H. SHUBERT	112 ➡
	RICHARD VINROOT	113 ➡

## NON PARTISAN PRIMARY

JUDGE OF COURT OF APPEALS You May Vote for One Puedes votar para uno	BARBARA JACKSON	211 ➡
	MARVIN SCHILLER	212 ➡
	ALAN THORNBURG	213 ➡
	MARCUS W. WILLIAMS	214 ➡

# FORSYTH COUNTY BOARD OF ELECTIONS

FORSYTH COUNTY GOVERNMENT CENTER  
201 N. CHESTNUT ST. • WINSTON-SALEM, NC 27101  
Telephone 703-2800

OFFICE HOURS: Monday - Friday 8:00 A.M. to 5:00 P.M.

VOTER REGISTRATION DEADLINE, FRIDAY JUNE 25, 2004

**“One-Stop” No Excuse Absentee Voting at the  
Forsyth County Board of Elections  
201 N. Chestnut St. • Winston-Salem, NC 27101  
July 1, 2004 - July 16, 2004 - 8:00 am - 5:00 pm  
July 17, 2004 - 10:00 am - 1:00 pm**

## FORSYTH COUNTY BOARD OF ELECTIONS PRECINCTS AND DISTRICTS

## FORSYTH COUNTY BOARD OF ELECTIONS PRECINCTS AND DISTRICTS

			CONG	SEN	HOUSE	COM
703	ARDMORE BAPTIST CHURCH	501 MILLER STREET	05	31	74	B
301	ASHLEY ELEMENTARY SCHOOL	1647 E. 21ST STREET	12	32	71	A
014	BEESONS CROSSROADS FIRE	1105 OLD SALEM ROAD	05	31	73	B
021	BELEWS CREEK FIRE STA	7675 GOODWILL CHURCH RD	05	31	73	B
905	BETHABARA MORAVIAN CH.	2100 BETHABARA ROAD	12	32	72	B
101	BETHANIA MORAVIAN CHURCH	5545 MAIN STREET	12	31	32 74 72	B
201	BROWN/DOUGLAS REC CTR	4725 INDIANA AVENUE	12	32	72	A
902	BRUNSON ELEMENTARY	155 N HAWTHORNE ROAD	12	32	74 71	A
807	CALVARY BAPTIST-BOY SCOUT HUT	5000 COUNTRY CLUB ROAD	05	31	75	B
305	CARVER HIGH SCHOOL	3545 CARVER SCHOOL ROAD	12	32	72	A
063	CASH ELEMENTARY SCHOOL	4700 OLD HOLLOW ROAD	05	31	73	B
054	CLEMMONS CIVIC CENTER	2870 MIDDLEBROOK DRIVE	05	31	75	B
051	CLEMMONS ELEMENTARY	6200 BINGHAM AVENUE	05	31	75	B
052	CLEMMONS PRESBYTERIAN	3910 HIGHWAY 158	05	31	75	B
808	COUNTRY CLUB FIRE STA	4700 COUNTRY CLUB	05	31	32 75	B
506	COVENANT PRESBYTERIAN	3827 KONNOAK DRIVE	12	32	75 71	A
082	EAST FORSYTH HIGH SCHOOL	2500 W MOUNTAIN STREET	12	32	72 71 74	A
404	EAST WINSTON HERITAGE CENTER	1110 E 7TH STREET	12	32	71	A
505	EASTON ELEMENTARY SCHOOL	734 E CLEMMONSVILLE	12	32	71	A
042	FELLOWSHIP BAPTIST	1075 TEAGUE ROAD	12	32	73 71 75	B
602	FIRST ALLIANCE CHURCH	1601 POPE ROAD	05	32	75 71	B
701	FIRST CHRISTIAN CHURCH	2320 COUNTRY CLUB ROAD	05	31	74	B
502	FOREST PARK ELEMENTARY	2019 MILFORD STREET	12	32	71	A
123	FORSYTH FRIENDS MEETING	800 JONESTOWN ROAD	05	31	32 75	B
304	FORSYTH TECH CC-WOODRUFF CTR	4905 LANSING DRIVE	12	32	72	A
705	FORSYTH TECH WEST CAMPUS	1300 BOLTON STREET	05	31	32 75	B
402	FOURTEENTH STREET REC	2020 FOURTEENTH STREET	12	32	71	A
043	FRIEDLAND MORAVIAN	2750 FRIEDLAND CHURCH RD	12	31	32 73 71	B
011	GLENN HIGH SCHOOL	1600 UNION CROSS ROAD	05	31	73	B
068	GOOD SHEPHERD MORAVIAN	1474 KERNER RD	05	31	73	B
707	GREEK ORTHODOX CHURCH	435 KEATING DRIVE	05	31	32 74	B
122	GRIFFITH FIRE STATION	5190 PETERS CREEK PW	05	32	75 71	B
903	HANES COMMUNITY CENTER	610 COLISEUM DRIVE	12	32	72	A
302	HANES/LOWRANCE MIDDLE SCHOOL	2900 INDIANA AVENUE	12	32	72	A
504	HILL MIDDLE SCHOOL	2200 TRYON STREET	12	32	71	A
055	HOLY FAMILY CATHOLIC CHURCH	4820 KINNAMON ROAD	05	31	75	B
083	IBRAHAM ELEMENTARY	5036 OLD WALKERTOWN ROAD	12	32	74 72	A
809	JEFFERSON MIDDLE SCHOOL	3500 SALLY KIRK ROAD	05	31	74	B
204	JOEUVETERANS COLISEUM	2825 UNIVERSITY PARKWAY	12	32	72	A
064	KERNERSVILLE ELEMENTARY	512 W MOUNTAIN STREET	05	31	73	B
061	KERNERSVILLE LIBRARY	130 E MOUNTAIN STREET	05	31	73	B
067	KERNERSVILLE RECREATION	1391-C SOUTH PARK DRIVE	05	31	73	B
034	KINGSWOOD UNITED METH	6840 UNIVERSITY PARKWAY	05	31	74	B
603	LATHAM ELEMENTARY	986 HUTTON STREET	12	32	71	B
403	LEAP ACADEMY AT KENNEDY	1000 N HIGHLAND AVENUE	12	32	71	A
071	LEWISVILLE ELEMENTARY SCH	6500 LUCY LANE	05	31	75	B
075	LEWISVILLE LIBRARY	6497 SHALLOWFORD ROAD	05	31	75	B
708	LITTLE CREEK RECREATION	610 FOXCROFT DRIVE	05	32	75	B
092	MACEDONIA BAPTIST CHURCH	6816 DORAL DRIVE	05	31	74	B
203	MARTIN LUTHER KING REC	2001 PITTSBURG AVENUE	12	32	72	A
074	MEADOWLARK MIDDLE SCHOOL	301 MEADOWLARK DRIVE	05	31	75	B

			CONG	SEN	HOUSE	COM
805	MESSIAH MORAVIAN CHURCH	1401 N PEACE HAVEN ROAD	05	31	74	B
702	MILLER PARK RECREATION	400 LEISURE LANE	05	31	74	B
306	MINERAL SPRINGS ELEM SCH	4527 OGBURN AVENUE	12	32	72	A
904	MISSION HISPANA	4637 TIM ROAD	12	32	72	A
906	MT TABOR HIGH SCHOOL	342 PETREE ROAD	05	31	74	B
207	NEW HOPE UNITED METH	5125 SHATTALON DRIVE	12	32	72	A
206	NORTH HILLS ELEMENTARY	340 ALSPAUGH DRIVE	12	32	72	A
032	NORTHWEST MIDDLE SCHOOL	5501 MURRAY ROAD	05	31	32 74 72	B
081	OAK SUMMIT UNITED METH	732 OAK SUMMIT ROAD	12	32	72	A
908	OLD TOWN BAPTIST CHURCH	4386 SHATTALON DRIVE	05	32	74 72	B
909	OLD TOWN RECREATION CTR	4550 SHATTALON DRIVE	05	32	74 72	B
205	PAISLEY MIDDLE SCHOOL	1400 GRANT AVENUE	12	32	72	A
605	PARKLAND HIGH SCHOOL	1600 BREWER ROAD	12	32	75 71	A
704	PARKWAY UNITED CHURCH	2151 SILAS CREEK PARKWAY	05	31	32 75 71	B
132	PPAFFTOWN CHRISTIAN CHURCH	3323 TRANSOU ROAD	05	31	74	B
606	PHILO MIDDLE SCHOOL	410 HAVERHILL STREET	12	32	71	B
601	PIEDMONT BAPTIST COLLEGE	ACADEMY AT BROAD STREET	05 12	32	74 71	B
066	PINEY GROVE ELEMENTARY	1500 PINEY GROVE ROAD	05	31	73	B
062	PINEY GROVE FIRE STATION	1109 PINEY GROVE ROAD	05	31	73	B
801	POLO PARK RECREATION CTR	1850 POLO ROAD	05	31	74	B
303	PRAISE ASSEMBLY OF GOD	2001 E 25TH STREET	12	32	72	A
111	PROVIDENCE MORAVIAN CHURCH	929 OLD HOLLOW ROAD	05	31	74 72	B
901	REYNOLDS HIGH GIRLS GYM	1404 NORTHWEST BLVD	05	31	74	B
065	ROBINWOOD AT KVILLE	230 HOPKINS ROAD	05	31	73	B
031	RURAL HALL ELEMENTARY	275 COLLEGE STREET	05	31	74 72	B
013	SEDGE GARDEN ELEMENTARY	475 SEDGE GARDEN ROAD	05	31	32 73	B
507	SEDGE GARDEN REC CTR	401 ROBBINS ROAD	12	31	32 73 71	A
804	SHERWOOD FOREST ELEM SCH	1055 YORKSHIRE ROAD	05	31	74	B
133	SHILOH LUTHERAN CHURCH	703 LEWISVILLE-VIENNA RD	05	31	75 74	B
405	SIMS RECREATION CENTER	1201 ALDER STREET	12	32	71	A
706	SOUTH FORK ELEMENTARY	4332 COUNTRY CLUB ROAD	05	31	74	B
015	SOUTHEAST MIDDLE SCHOOL	1200 OLD SALEM RD	05	31	73	B
072	SOUTHWEST ELEMENTARY	1631 SOUTHWEST SCHOOL RD	05	31	75	B
501	ST ANDREWS METHODIST	1840 BUTLER STREET	12	32	71	A
033	ST ANDREWS PRESBYTERIAN	357 OLD HOLLOW ROAD	12	31	32 74 72	B
907	ST ANNE'S EPISCOPAL	2690 FAIRLAWN DRIVE	05	31	72	B
802	SUMMIT SCHOOL	2100 REYNOLDA ROAD	05	31	74	B
091	TOBACCOVILLE COMMUNITY CENTER	4225 TOBACCOVILLE ROAD	05	31	74	B
503	TRINITY MORAVIAN CHURCH	220 E SPRAGUE STREET	12	32	71	A
806	TRINITY UNITED METHODIST	3819 COUNTRY CLUB ROAD	05	31	74	B
012	UNION CROSS ELEMENTARY	4300 HIGH POINT ROAD	05	31	73	B
073	UNITY MORAVIAN CHURCH	8300 CONCORD CHURCH ROAD	05	31	75	B
053	VFW POST 9010	4615 HAMPTON ROAD	05	31	75	B
131	VIENNA ELEMENTARY SCHOOL	1975 CHICKASHA ROAD	05	31	74	B
112	WALKERTOWN LIBRARY	2969 MAIN STREET	05	31	74 73	B
709	WARD ELEMENTARY SCHOOL	3775 FRATERNITY CHURCH RD	05	32	75	B
607	WESTVIEW BAPTIST CHURCH	1700 EBERT STREET	05	32	75	B
803	WHITAKER ELEMENTARY	2600 BUENA VISTA ROAD	05	31	74	B
401	WINSTON LAKE FAMILY YMCA	901 WATERWORKS ROAD	12	32	71	A
604	WSFC SCHOOLS ADMINISTRATION	1605 MILLER STREET	12	32	74 71	B